

KOPAL MAXIBLOC VERTICAL CLAMPING SYSTEM

Steel clamp for heavy machining
Powerful clamping
Retractable arm
Extremely compact clamp



Maxibloc

With clamping key, extension key and special clamping screw. Steel body and clamping arm.

Clamping Force	Reach	Clamping Height	Torque	Ref.
35000 N.	50	86 mm	70 N.m	06-310
Nickel-plated clamping key, height 88 mm				06-325
Extension key				06-726



For T-slot tables with slot size from 16 mm and M 14 and M 16 modular tables.
 Mounting with 1 screw.
 Compact clamp with direct workpiece clamping.
 Very simple course adjustment and retraction of clamping arm.

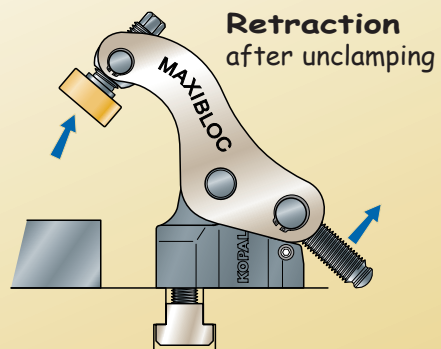
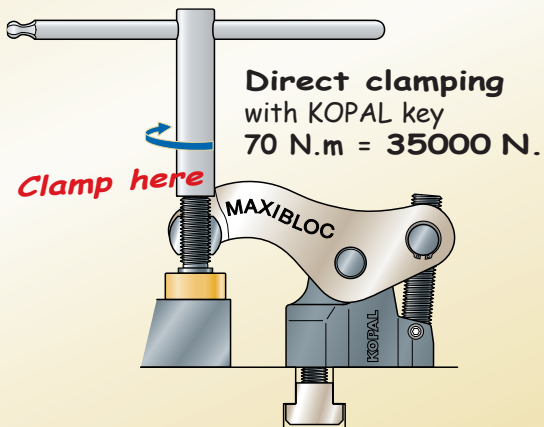
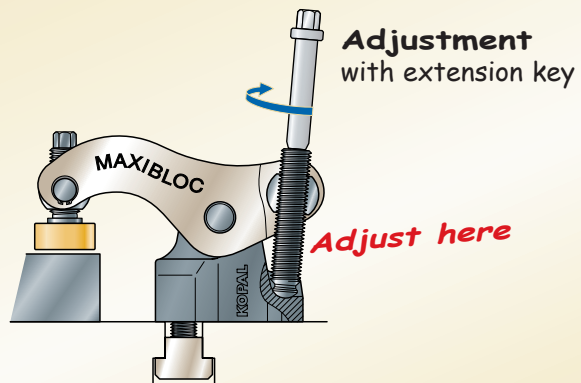
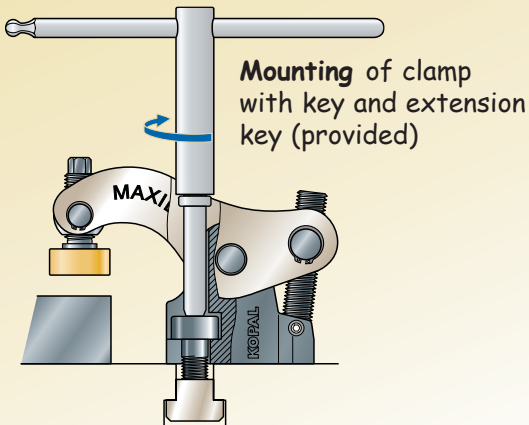

Mounting screws Ref.

Special 8 mm large-head hexagonal socket screws,

- M 14 x 40 mm 06-720
- M 16 x 44 mm 06-721
- M 16 x 60 mm 06-723

Riser block

Steel stackable riser block, supplied with a M 14 mounting screw

- 80 mm riser block 06-320

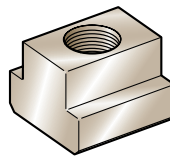
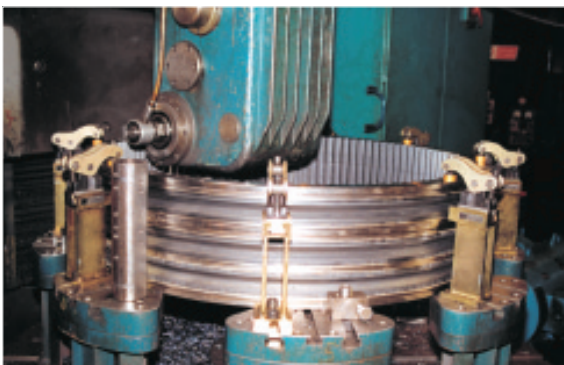
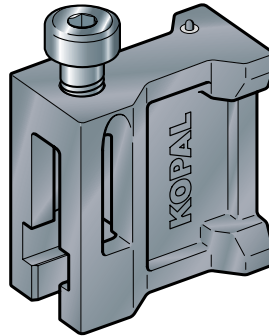
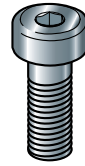

T-nuts Slot size	M 14 Ref.	M 16 Ref.
16 mm	90-202*	
18 mm	90-205	90-250
20 mm	90-210	90-255
22 mm	90-215	90-260
24 mm	90-220	90-265
28 mm	90-225	90-270

* long T-nut

