

Ref.

09-451

Standard kit 10000 Newton

Comprising :

- 1 Driving clamp 09-090
(2 x M6 clamping screws)
- 1 standard moving clamp / locator 09-610
- 1 standard M 10 clamp / locator 09-140
- Clamping screw and clamping key



Machining assembly is carried out according to workpiece dimensions

Simple and compact assembly
Quick clamping
Clamping power
Multiple applications

Clamping force : 10000 Newton
Clamping torque : 12 N.m
Clamping range : 20 mm

Setting-up

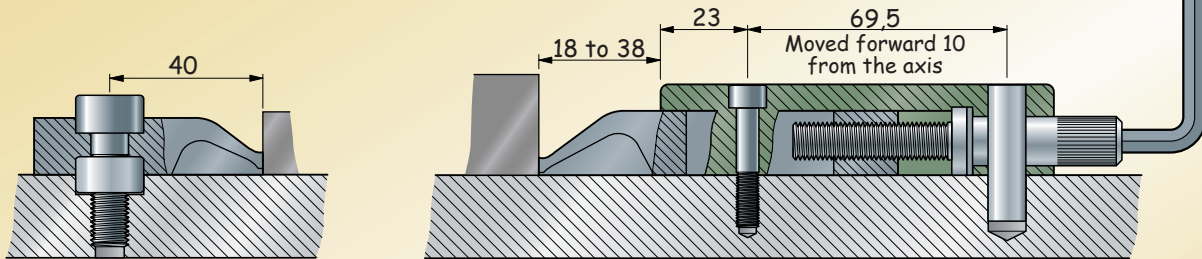

Drilling of :
1 x M 10 fixing hole
1 x Ø 18 H7 spot facing, depth 5mm

Drilling of : 2 fixing holes
M 6 - 37mm centre distance
1 x Ø 10 indexing hole, depth 12mm
(to resist thrust)

Clamping heights

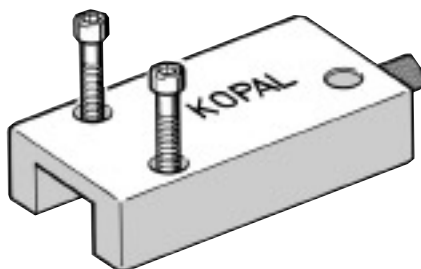
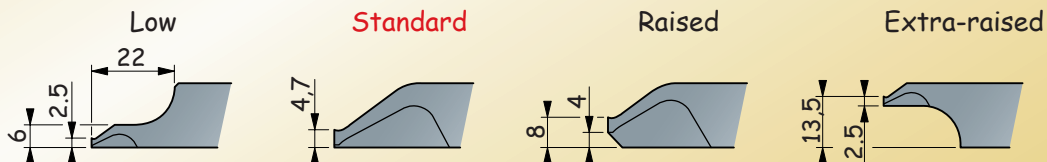

Clamp body

Ref.

Aluminium body for moving clamp/locators
(with pressure screw and clamping screw)

Table-mounted driving clamp

09-090

Fixed in place with 2 x M6 screws
and Ø 10 pinning

Moving clamps / locators for clamping body

Clamps made of spring steel
(work with the body pressure screw)

- Low moving clamp / locator 09-615
clamping height 2.5 mm
- Standard moving clamp / locator** 09-610
clamping height 4.7 mm
- Raised moving clamp / locator 09-620
clamping height 8 mm
- Extra-raised moving clamp / locator 09-625
clamping height 13.5 mm

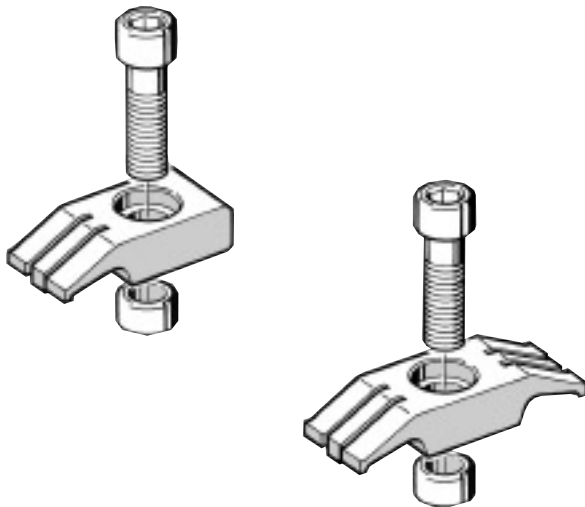
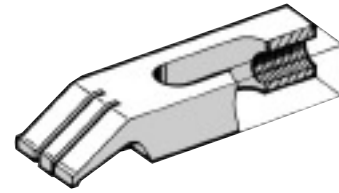
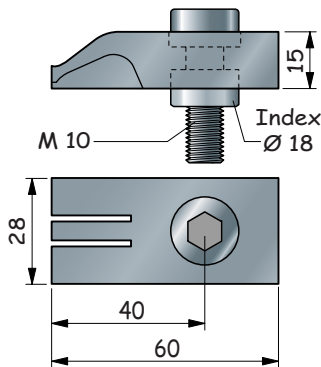

Table-mounted clamps / locators Ref.

Made of spring steel
(with clamping screw and Ø 18 mm locating)

- Low clamp / locator clamping height 2.5 mm
Mounted with M 10 09-143
- Standard clamp / locator** clamping height 6 mm
Mounted with M 10 09-140
- Extra-raised clamp / locator clamping height 13.5 mm
Mounted with M 10 09-142
- Standard double-ended clamp clamping height 6 mm
for clamping two facing workpieces
Mounted with M 10 09-145

Fixed clamps / locators
09-140 / 142 / 143



09-145

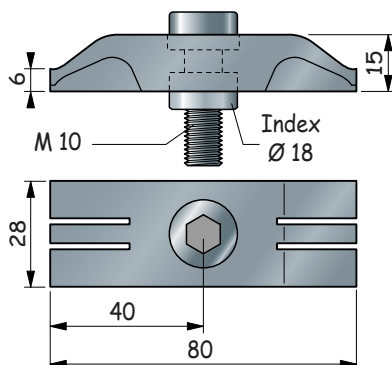

The contact side of the stops is rectified in relation to the centring locator, thus ensuring the workpiece is correctly positioned.



Moving clamps / locators
09-610 / 615 / 620 / 625

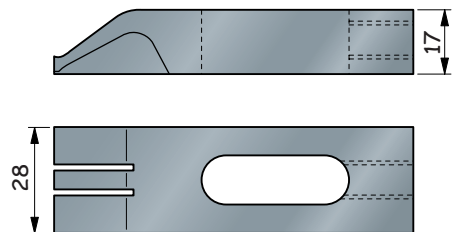

Driving clamp 09-090

